

Business Affairs Committee Facilities Update

July 27, 2023



UNIVERSITY *of* NORTH CAROLINA WILMINGTON

Action Item

Action Item #1:

Wrightsville Beach Aquaculture Storage Building Demolition

- The Wrightsville Beach Aquaculture storage building was installed in 1992 and is no longer suitable for continued use.
- UNCW seeks to demolish the building as the cost of renovating the facility would exceed its replacement value.
- BOT approval is required to demolish the building, as it was assigned a State Asset number when it was installed.

ACTION ITEM #1: The University is requesting the Board of Trustees approval for removal of the Wrightsville Beach Aquaculture Storage Building (State Asset 1-65-32-01) a 120 GSF (Gross Square Foot) storage facility procured and installed in 1992 located on the CMS – Wrightsville Beach leased site.

Please review the following slide:

Action Item #1: Wrightsville Beach Aquaculture Storage Building Demolition



Building Exterior

Capital Project Updates



*View of the Western Façade
of the Expansion*

Scope: Renovation and Expansion

Budget: \$61.5M

Source of Funds: State of NC

Status: Under Construction

Designer: LS3P

CMR: Balfour Beatty / Leeper Construction





*Courtyard Façade
from the NE*

View of the Courtyard Façade from the South

Outdoor Recreation Fields and Facilities Improvements



The project is bounded by The Shore Dining Hall, Terrapin/Pelican/Sandpiper Halls, the Leonard Recreation Center, and Walton Drive.

Outdoor Recreation Fields and Facilities Improvements



Outdoor Recreation Fields and Facilities Improvements



Outdoor Recreation Fields and Facilities Improvements



Pavilion Building

King Hall and Alderman Hall R&R (Repair and Renovation)



Alderman Hall
(as seen from the Quad Lawn)

Primary Scope:

- **Alderman Hall:** ADA Compliance, PM&E, Envelope, and Control Systems Revitalization
- **King Hall:** Reconfiguration of Space, ADA Compliance, PM&E, Envelope, and Control Systems Revitalization

Budget: \$10.84M

Source of Funds: FY21 Carryforward and Trusts

Status: Under Design

Designer: Mosley Architects

CMR: Muter Construction

Construction Phases:

King Renovations 2023/2024

Alderman Renovations 2024



King Hall
(Western Façade)

Center for Marine Science Repair and Renovation

Facility Systems Capital Renewal



Main Entrance

Scope: Laboratory Hood, PM&E, Building Envelope, and Building Control Systems Revitalization
Budget: \$993K (Design and Preconstruction Services Only)
Total Budget: \$9.93M
Source of Funds: State of NC
Status: Design Development
Designer: Moseley Architects
CMR: Samet Corporation



Mechanical Room

IBEC - Planning and Design Initiative

Project Overview

Scope: Planning and Design for new IBEC Facility

Budget: \$994k (Design and Preconstruction Services Only)

Source of Funds: State of NC*

Status: Schematic Design w/ NHCS

Designer: LS3P

CMR: Barnhill Contracting

**Funding for construction will be the responsibility of NHCS.*

Proposed Site Layout



IBEC - Planning and Design Initiative

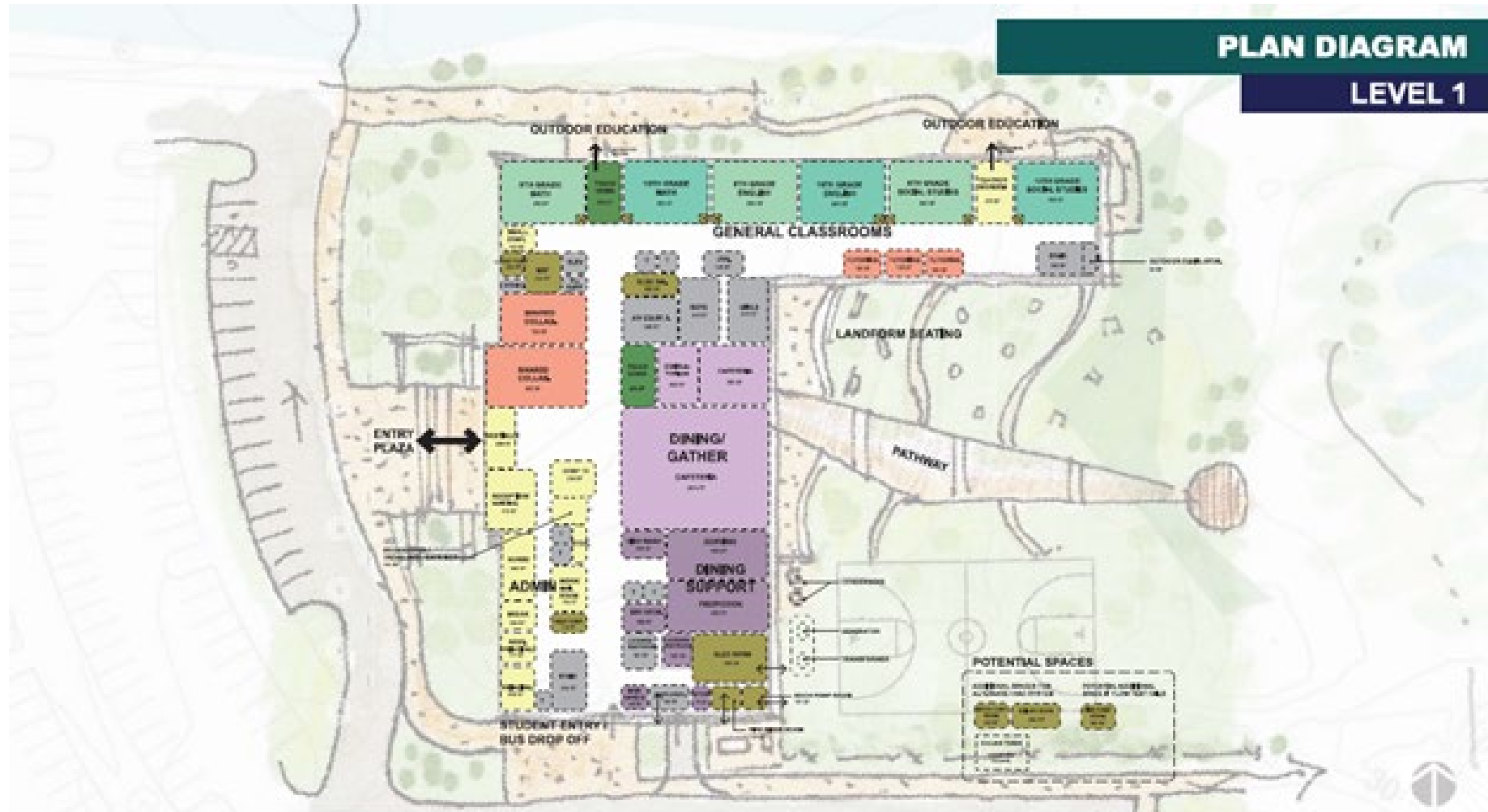

1st Level Blocking Diagram

IBEC - Planning and Design Initiative

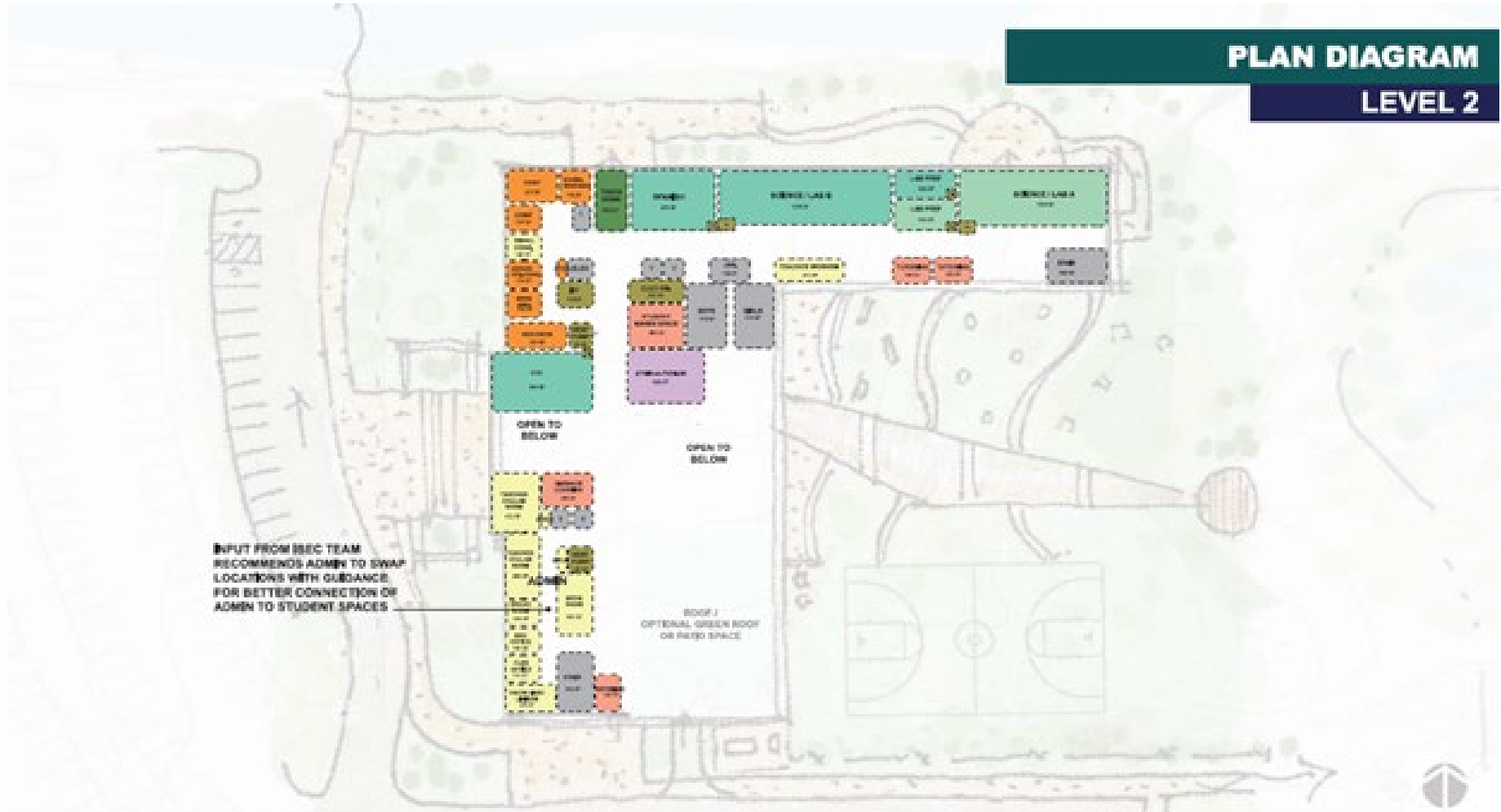

Project Authorizations

| Project | Budget | Funding Authority | BOT Siting Approval | BOT Aesthetic Approval |
|--|----------|---------------------------------------|---------------------|------------------------|
| Randall Library Expansion & Renovation | \$62M | Legislature - 2018 BOG – Apr. 2022 | Oct. 2020 | April 2021 |
| Outdoor Recreation Fields and Facilities Improvements Phase I & II | \$9.75M | Legislature - 2021 | April 2022 | July 2022 |
| Alderman & King Halls R&R | \$10.84M | BOG - Sept 2021, Feb. 2023 | N/A | N/A |
| CMS PM&E Refurbishments (Design and Preconstruction Only) | \$993K | BOG - Dec. 2021 | N/A | N/A |
| Westside Energy Plant Upgrades | \$2.95M | BOG - Feb. 2022 | N/A | N/A |
| Natatorium Lighting and Filtration System Improvements | \$675K | BOT – Jan. 2023 | N/A | N/A |
| Wagoner/Hurst/Hamilton Roadway & Stormwater Improvements | \$1.3M | BOG – Nov. 2022 | N/A | N/A |
| Cadaver Lab Upfit | \$1.5M | BOG – Apr. 2021 | N/A | N/A |
| IBEC Pre-Planning | \$994K | Legislature - 2022 | N/A | TBD |
| Galloway Demolition | \$2.0M | BOG - Jan. 2023 | N/A | N/A |

Informal Project Updates



Cultural Arts Building – Beckwith Recital Hall Refurbishment



Previous (2006) Color Scheme

Cultural Arts Building – Beckwith Recital Hall Refurbishment



Revised Color Scheme



Loggerhead Hall and Terrapin Hall Connecting Arbor

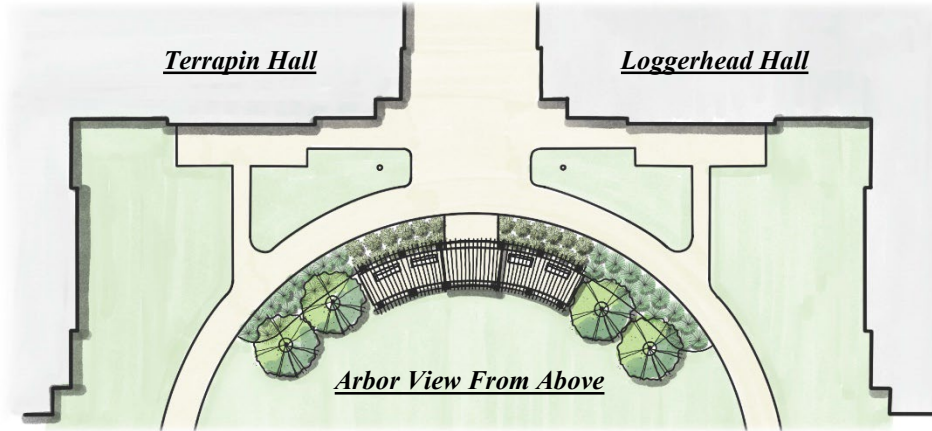

Arbor Is To Be Centered Between And To The West of Terrapin and Loggerhead Halls

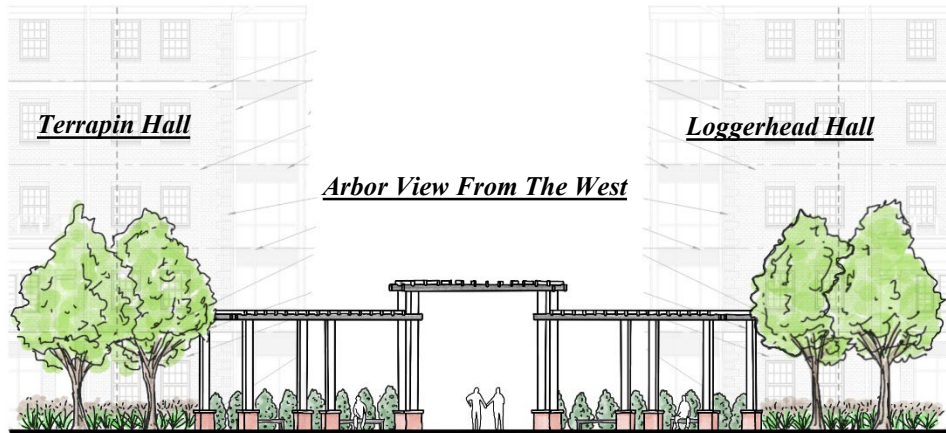

Loggerhead Hall and Terrapin Hall Connecting Arbor



Senior Day of Service 2023

Refurbishment of the 2001 Senior Class Gift



2023/2024 Campus Master Plan Update



Campus Master Planning: Background

Master planning provides a long-term vision and framework for the development and growth of our campus. It involves strategic planning, coordination, and decision-making to guide the physical, functional, and environmental aspects of the campus. This effort is a strategic and holistic process that guides a vibrant, functional, and sustainable campus environment in support of the academic mission while enhancing the student experience and fostering a sense of community.

Key objectives and purposes include:

- Informing Campus Development
- Supporting Academic and Research Goals
- Optimizing Space Allocation/Use on Campus
- Enhancing Sustainability and Efficiency of Campus
- Informing Infrastructure Planning
- Enhancing Campus Identity and Brand
- Promoting Community Engagement
- Guiding Financial and Resource Planning

Campus Master Planning: Background

Leadership & Support

- **Executive Leadership Team:** Charged with guiding the development and implementation of a comprehensive and inclusive campus master plan that aligns with the University's strategic vision and goals.
- **Action Team:** Charged with supporting the efforts of the Executive Leadership Team by conducting research and developing recommendations on specific aspects of the campus master plan.
- **Designer:** Hanbury (with supplemental support from Populous)

Broad Engagement (including, not limited to):

- | | |
|---|---|
| - Shared Governance Structures | - Community Engagement & Impact |
| - Academic College Leadership | - Board of Trustees |
| - Office of Undergraduate Education and Faculty Affairs | - Center for Marine Sciences |
| - Institutional Research and Planning | - Athletics |
| - Student Engagement, Enrollment, and Retention | - Office of Global Partnerships and International Education |
| - Office of Research and Innovation | - Business Services |
| - Housing and Residence Life | - Student Recreation |
| | - Campus Life |



Campus Master Planning: Timeline Update

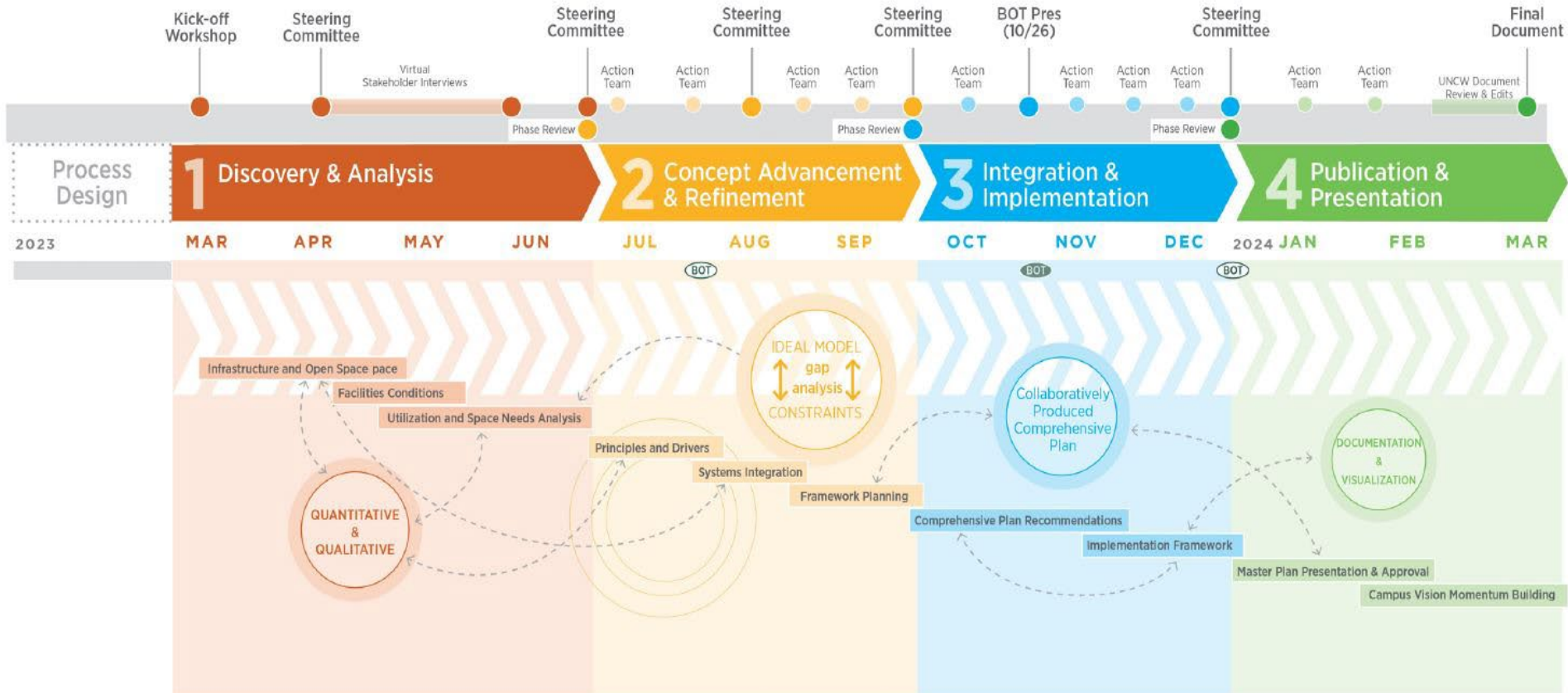

Project Timeline



Questions



UNIVERSITY *of* NORTH CAROLINA WILMINGTON